

GLUING WITH A HOT GLUE GUN

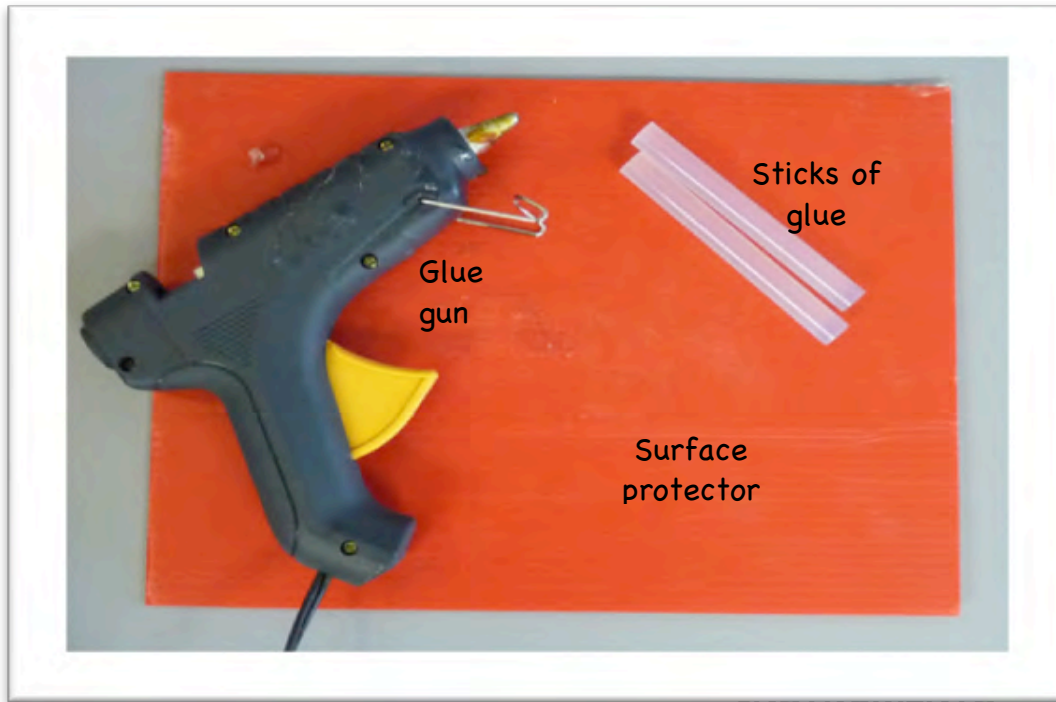

Method for gluing small objects

Put a drop of glue on the larger surface.



Place the object on the drop of glue.



GLUING WITH A HOT GLUE GUN (continued)

If you are gluing thin plastic pieces, avoid leaning the nozzle (tip) of the gun on the part. This may cause the part to melt or become distorted.

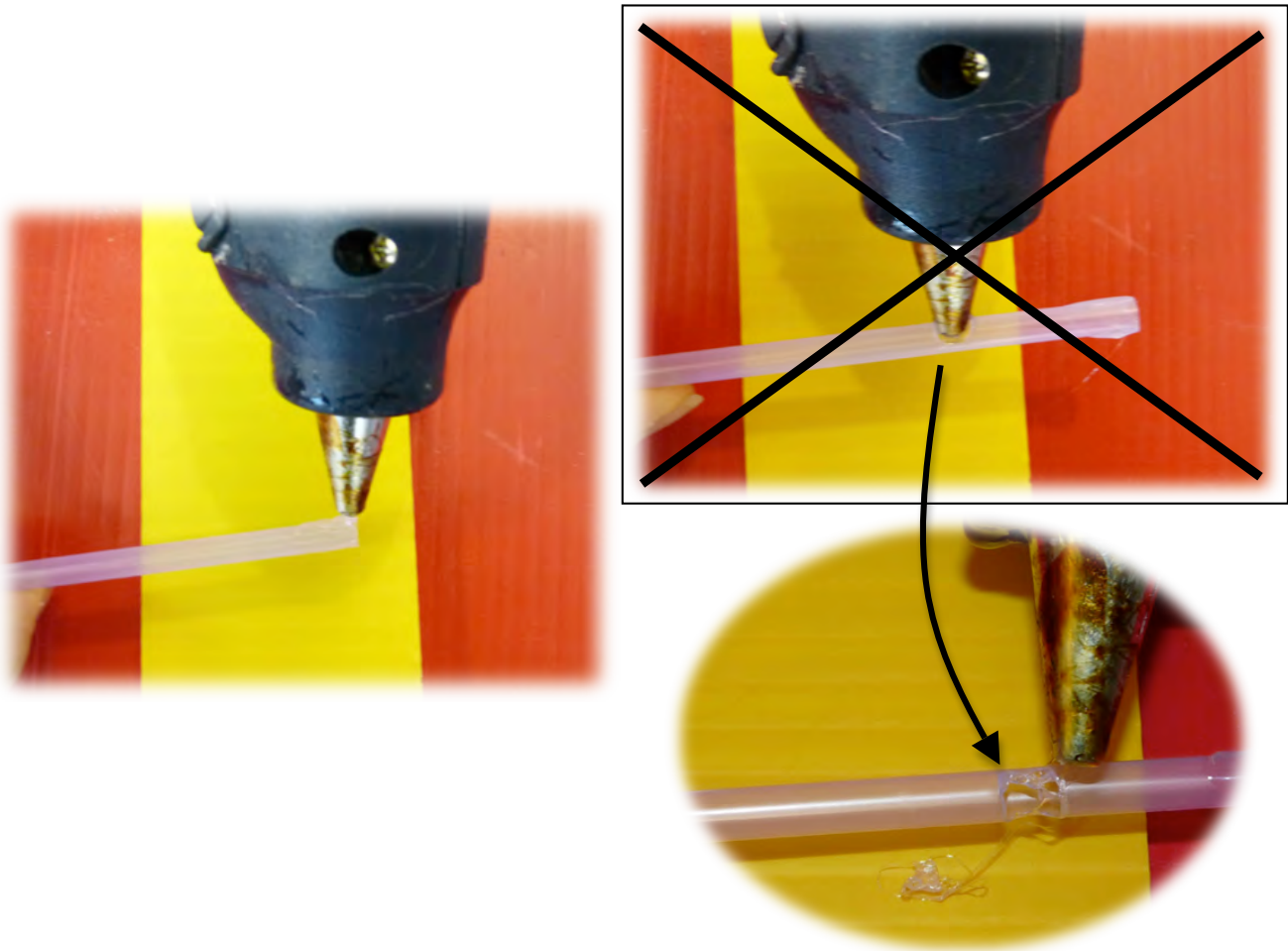

CAREFUL! Never touch the nozzle (tip) of the gun or the molten glue, since this may cause burns.

After the glue is applied, you must work quickly before the glue hardens.

It is important not to apply the glue on a cold surface, since it will harden too quickly and this will prevent the parts from adhering.